



Showers

DC 4141

DC COLLECTION

Design Wetstyle Design Lab



FEATURES

Handcrafted in Montreal, Canada

Drain location: corner

No membrane or floor slope construction is needed

Made of WETMAR BiO, which is naturally slip-resistant

TECHNICAL DETAILS

- **Width:** 41"
- **Length:** 41"
- **Height:** 1.5"
- **Weight:** 56 lbs / 25 kg

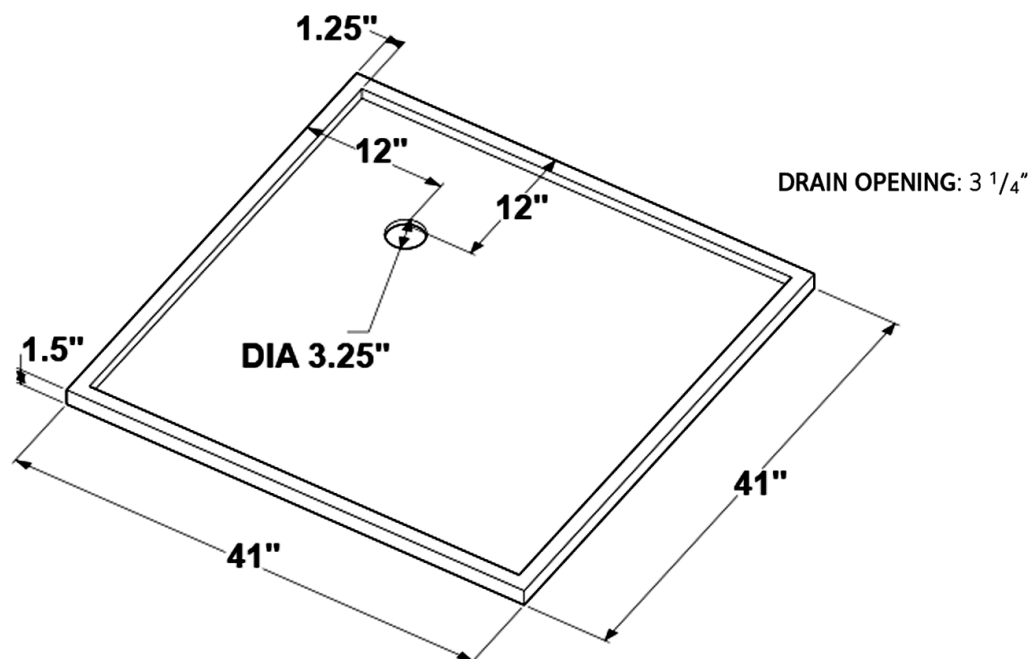

DC 4141

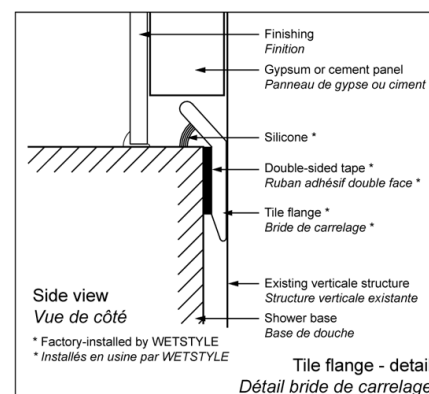

WETSTYLE cannot be held responsible for any technical errors and reserves the right to make revisions without notice. Approximate measurement. The manufacturer accepts 1/4" (6.35mm) variance.

AVAILABLE CONFIGURATIONS

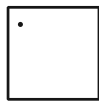

DC414101 - No Tile Flange

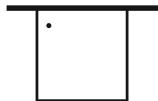

DC414102L - Left Drain - Back Wall

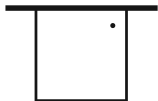

DC414102R - Right Drain - Back Wall

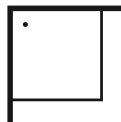

DC414104L - Left Drain - Left and Back Walls

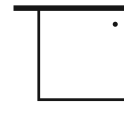

DC414105R - Right Drain - Right and Back Walls

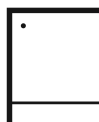

DC414106L - Left Drain - Three Wall Alcove

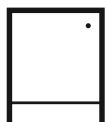

DC414106R - Right Drain - Three Wall Alcove

OPTIONS

Model

- DC364801 - No Tile Flange
- DC364802 - Back Wall
- DC364804 - Left and Back Walls
- DC364805 - Right and Back Walls
- DC364806 - Three Wall Alcove
- DC414101 - No Tile Flange
- DC414102L - Left Drain - Back Wall
- DC414102R - Right Drain - Back Wall
- DC414104L - Left Drain - Left and Back Walls
- DC414105R - Right Drain - Right and Back Walls
- DC414106L - Left Drain - Three Wall Alcove
- DC414106R - Right Drain - Three Wall Alcove

WETMAR BiO Finish

- White Matte (#MA)
- White True High Gloss (#GA)

NOTES

IMPORTANT - SHOWER INSTALLATION SUPPLIES: A 1/4" tile flange will be supplied to comply with the requested position. Installed at the factory to prevent water leakage, this must be placed directly on the partition framing prior to the installation of drywall. For installation, it is important to level the shower receptor in order to ensure maximum drainage.

DRAIN: Not supplied, any regular shower drain will fit